

3 NORTH ELEVATION - EXISTING
A1 SCALE 1/4" = 1'-0"



4 EAST ELEVATION - EXISTING
A1 SCALE 1/4" = 1'-0"



2 SOUTH ELEVATION - EXISTING
A1 SCALE 1/4" = 1'-0"



5 WEST ELEVATION - EXISTING
A1 SCALE 1/4" = 1'-0"

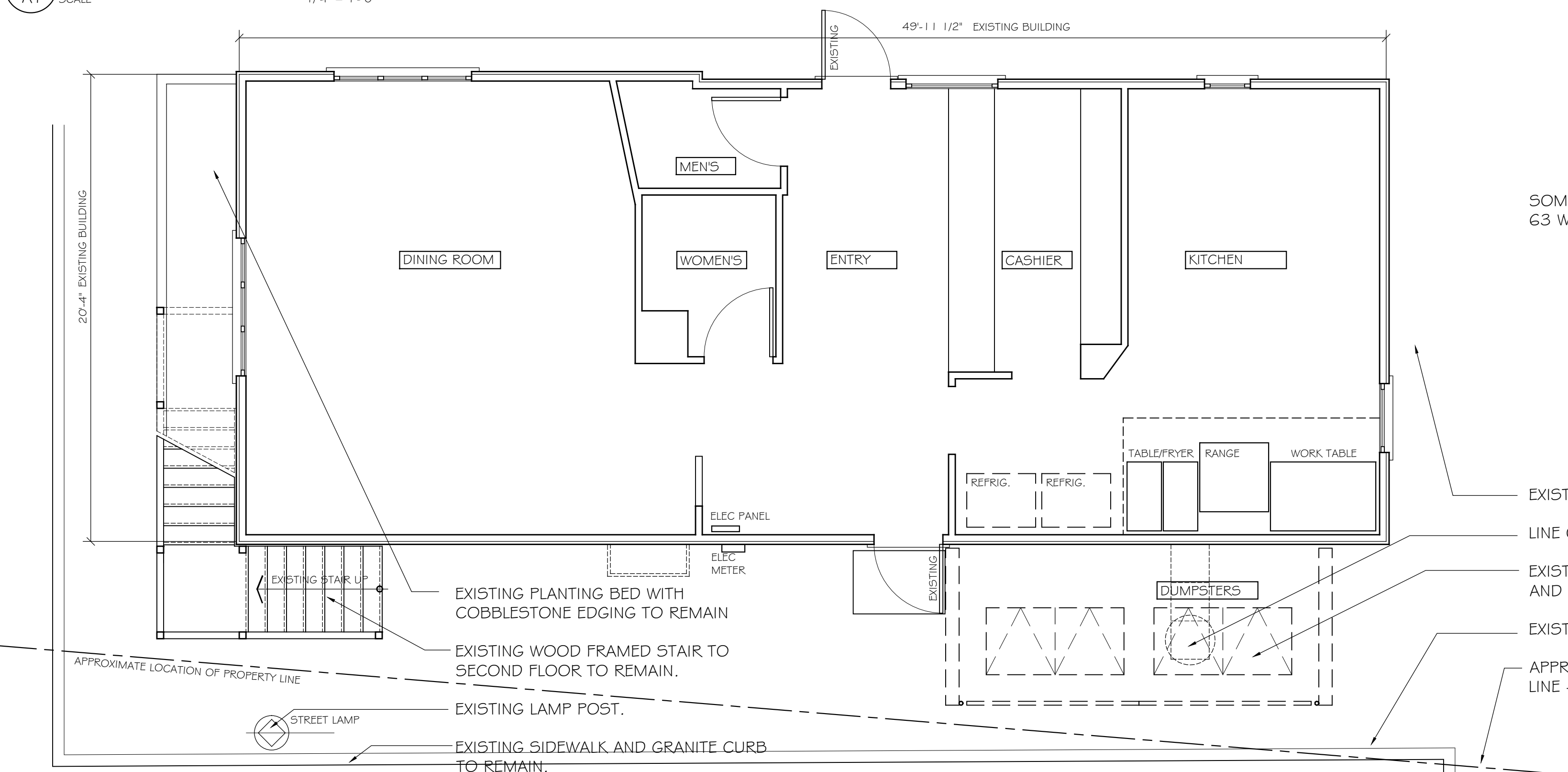

1 EXISTING FIRST FLOOR PLAN
A1 SCALE 1/4" = 1'-0"



6 KEY PLAN
A1 SCALE NONE

DRAWINGS ISSUED	
No.	DATE
01	05/19/2020 EXISTING CONDITIONS
02	05/28/2020 PRELIMINARY DESIGN
03	06/22/2020 FOOTPRINT REVISION
04	06/24/2020 HISTORIC APPLICATION
05	09/15/2020 ZBA APPLICATION

WALL TYPES LEGEND	
	EXISTING TO REMAIN
	EXISTING TO BE REMOVED
	NEW CONSTRUCTION SEE DETAILS AND NOTES

LIVE LOAD REQUIREMENTS	
LIVING AREAS	40 PSF LIVE LOAD
EXTERIOR DECKS	60 PSF LIVE LOAD
SLEEPING AREAS	30 PSF LIVE LOAD
STORAGE (W/O STAIR)	20 PSF LIVE LOAD
ATTIC (WITH STAIR)	30 PSF LIVE LOAD
ROOF SNOW LOAD	30 PSF LIVE LOAD

DEAD LOAD REQUIREMENTS	
TYPICAL FLOOR	10 PSF DEAD LOAD
BATH FLOORS	15 PSF DEAD LOAD
EXTERIOR WALLS	15 PSF DEAD LOAD
INTERIOR WALLS	10 PSF DEAD LOAD
WIND LOADING	100 MPH
SEISMIC LOADING	CLASS "D"
EXPOSURE CATEGORY	"B"

BUILDING CODES	
2015 International Building Code	
ANSI A117.1-2009 Accessibility Code	
2015 International Existing Building Code	
2015 International Plumbing Code	
2015 International Mechanical Code	
2015 International Residential Code	
2015 International Energy Conservation Code	
2017 National Electrical Code (NFPA 70)	
2018 Connecticut State Building Code Amendments	

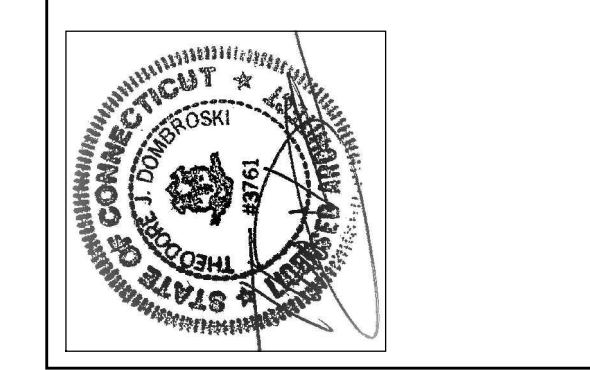

DOB	2020-11-11
DATE	05/19/2020
SCALE	1/4" = 1'-0"
DRAWN	TJD
CHECKED	TJD
REF.	2020-111 PLAN

SOM SIAM RESTAURANT
63 Whitfield Street Guilford, CT 06437
Prepared for: Whitfield & Water Shoppes, LLC
7 Laurel Hollow Rd. Guilford, CT.

EXISTING CONDITIONS

D O M B R O S K I
A R C H I T E C T S

SEVENTY ONE WHITFIELD STREET
GUILFORD, CONNECTICUT, 06437
Phone: (203) 453-3606 Fax: (203) 453-3633

A1